

# TENSA4

Portable  
Hammock  
Stand

# Setup Instructions

Page 1

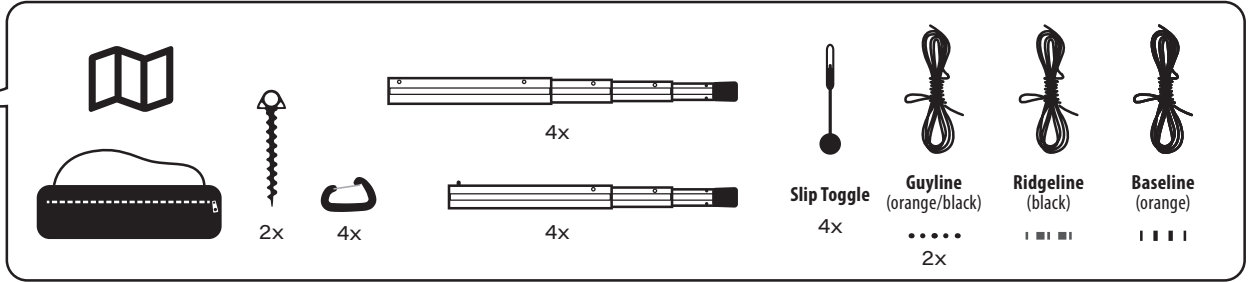

1

Assemble poles

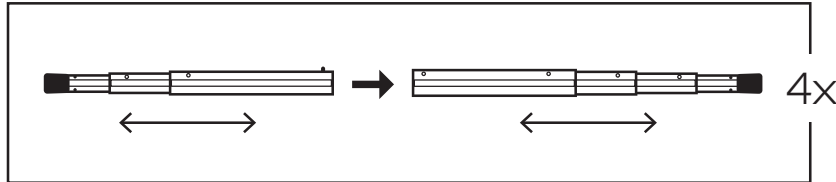

2

Connect pole ends with slip toggle

Connect baseline and ridgeline

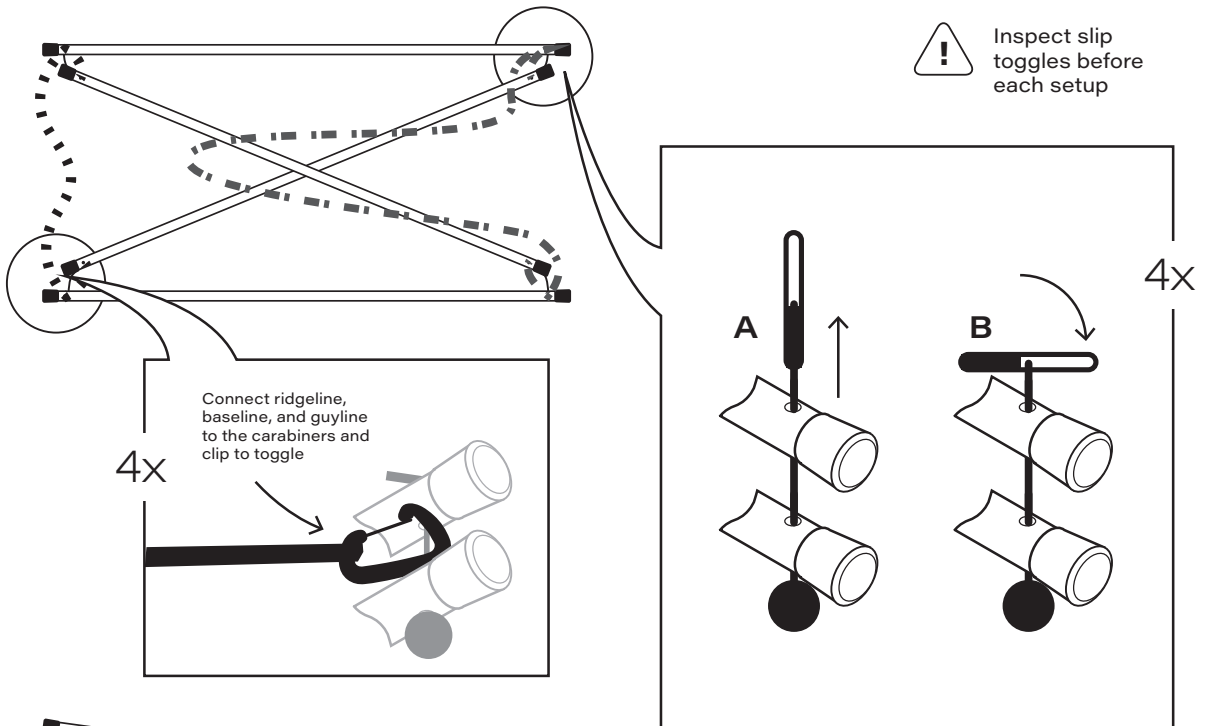

3

Spread baseline and add foot anchor

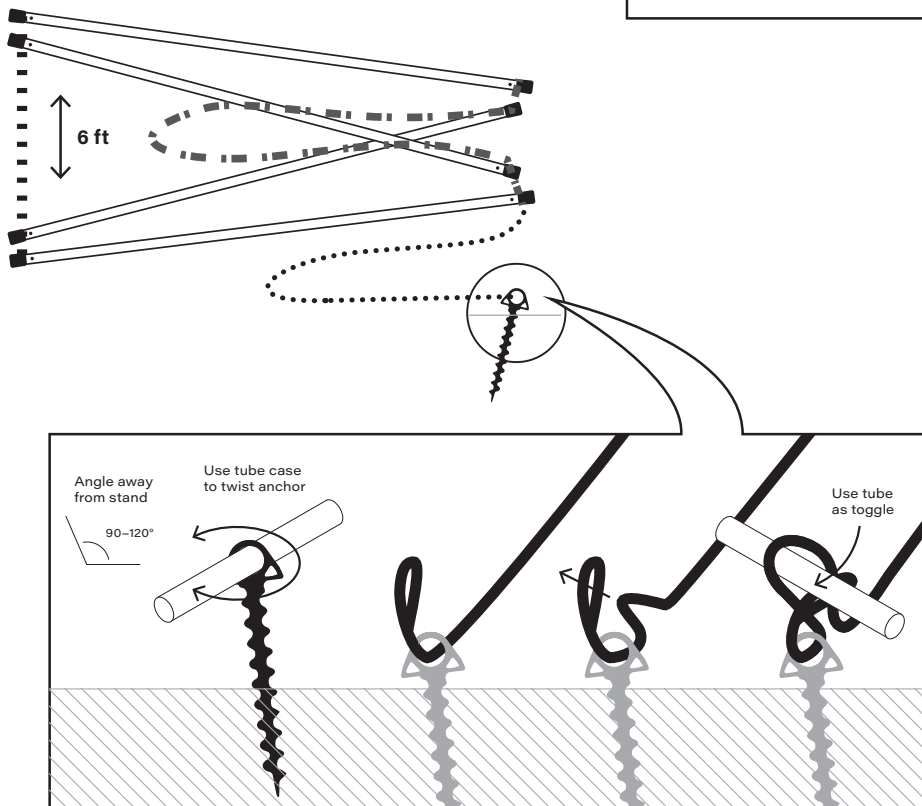

Turn over →

4

Erect stand

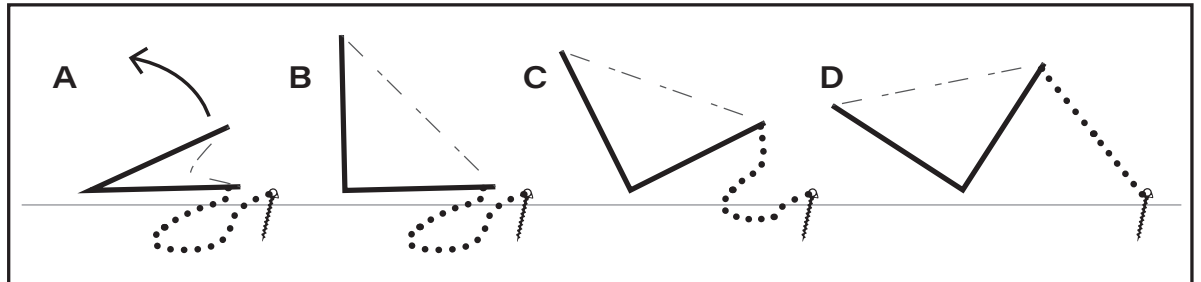

Head end **MUST** be lower than foot end

Head end

Ridgeline

Foot end

Guyline

5

Add head  
guyline  
(optional)

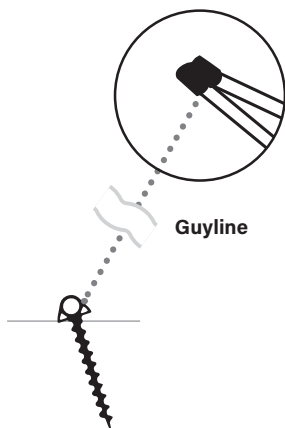

Guyline

Baseline

6

Attach  
hammock

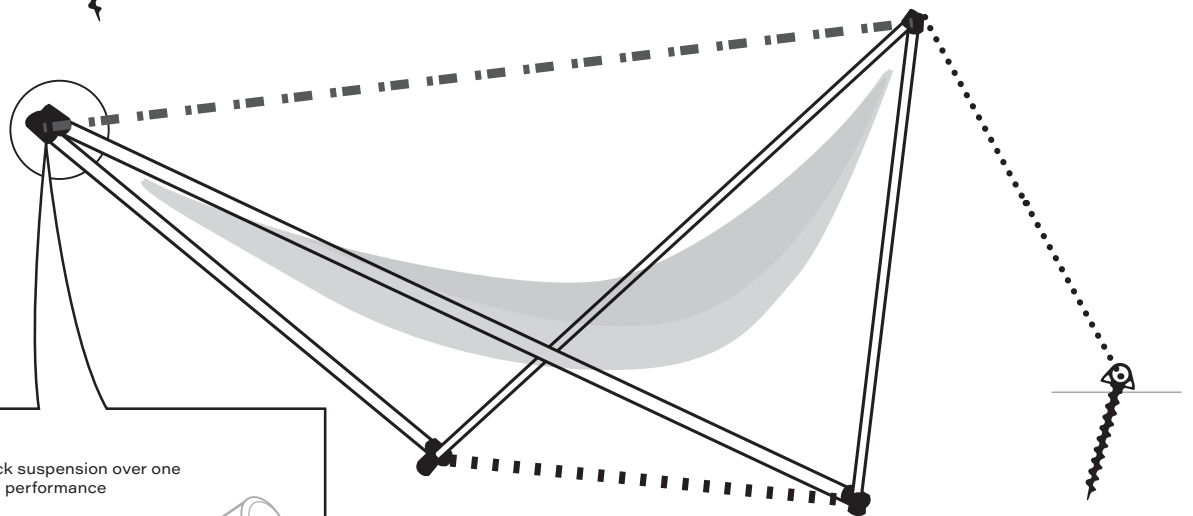

Attach hammock suspension over one pole for optimal performance

Ridgeline

Hammock suspension\*

Hammock\*



Head

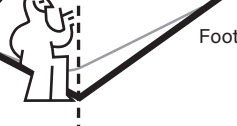

Foot



Head

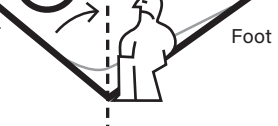

Foot



Snap this QR code  
for setup videos and tips



**Tensa  
Outdoor**

©2019 Tensa Outdoor | tensaoutdoor.com